

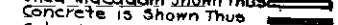

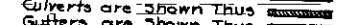

ABBREVIATIONS
 The Mark (') Indicates Foot or Feet
 The Mark (") Indicates Inch or Inches
 St. Indicates Street
 & Indicates Center Line
 The Mark (c) Indicates equals
 No. Indicates Number
 Oiled Macadam Shown Thus 
 Concrete is Shown Thus 
 Culverts are Shown Thus 
 Gutters are Shown Thus 
 (a) Indicates an angle iron $2 \times 2 \times \frac{1}{2}$

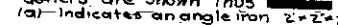

ENLARGED SECTION OF CONCRETE GUTTERS
 SCALE $\frac{1}{2}$ "=1'

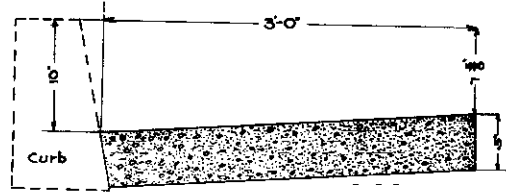
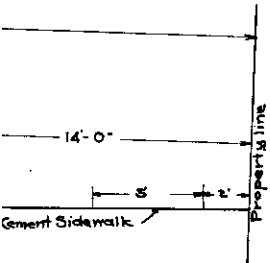
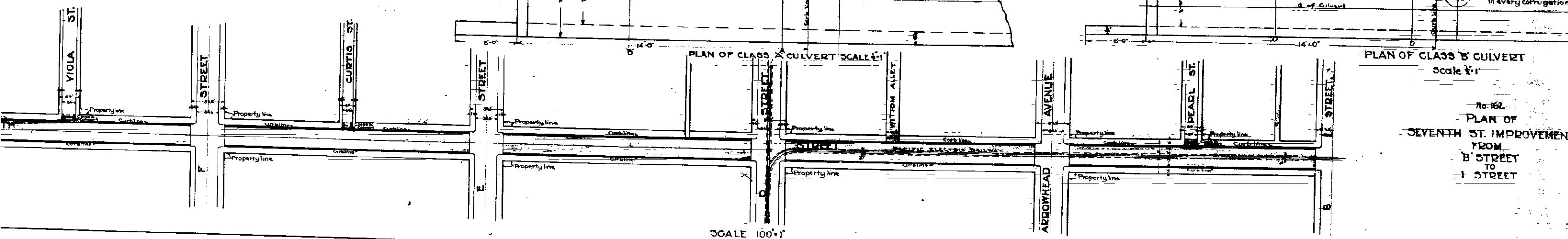
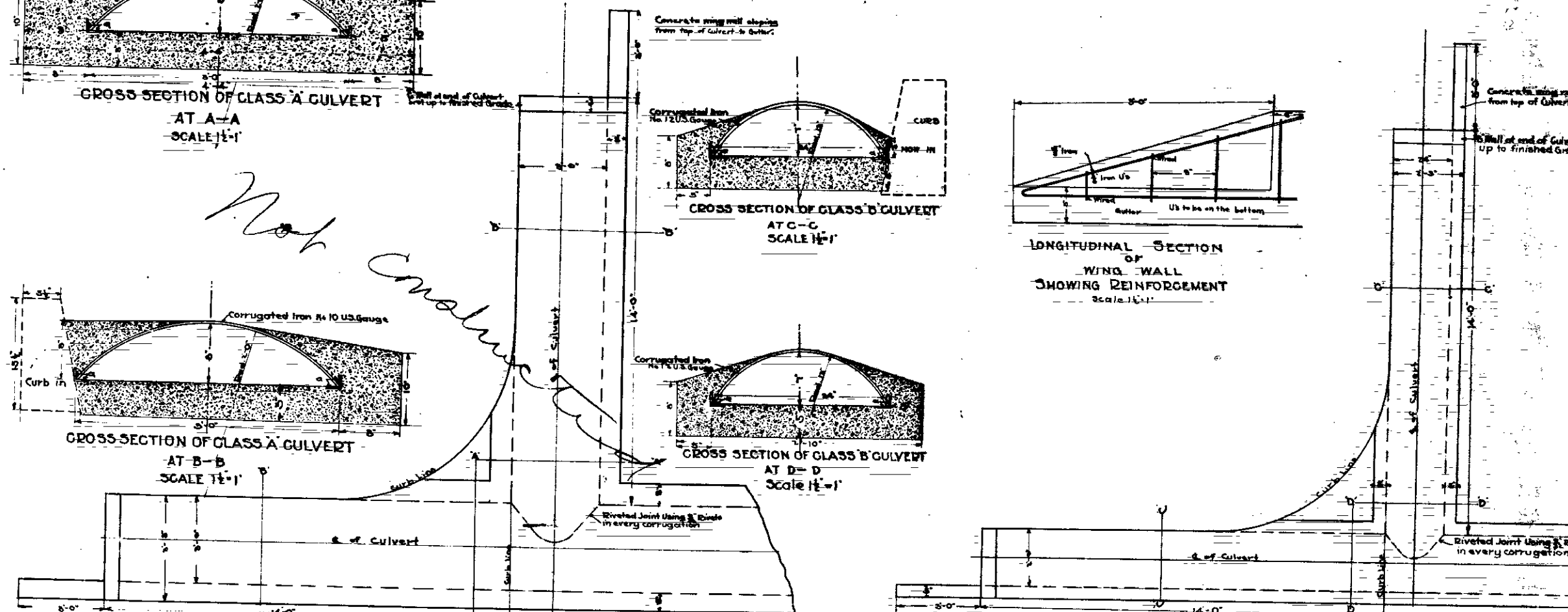
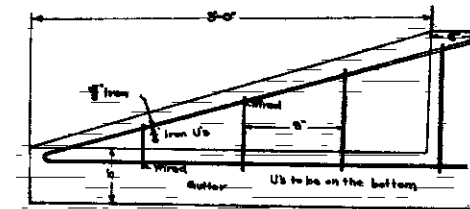
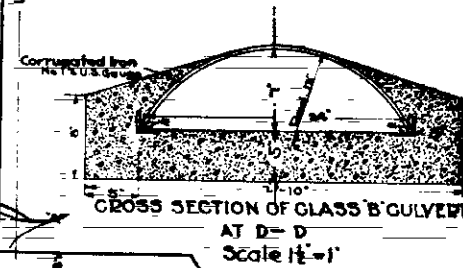
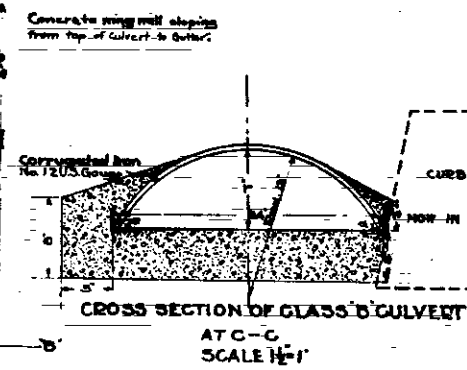
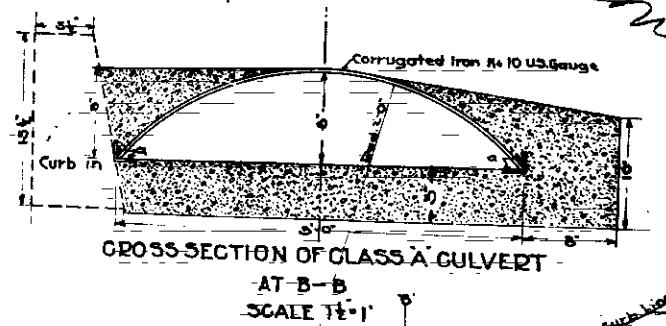
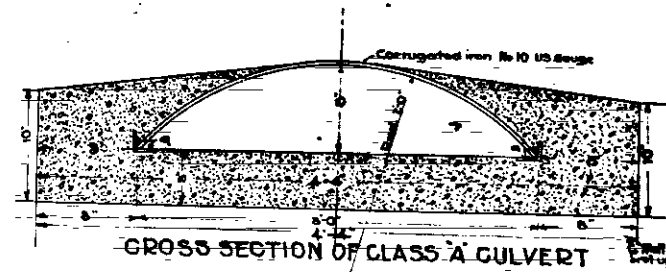
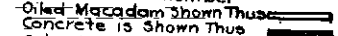
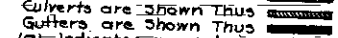

ABBREVIATIONS
 The Mark (') Indicates Foot or Feet
 The Mark (") Indicates Inch or Inches
 St. Indicates Street
 & Indicates Center Line
 The Mark (c) Indicates equals
 No. Indicates Number
 Oiled Macadam Shown Thus 
 Concrete is Shown Thus 
 Culverts are Shown Thus 
 Gutters are Shown Thus 
 (a) Indicates an angle iron $2 \times 2 \times \frac{1}{2}$

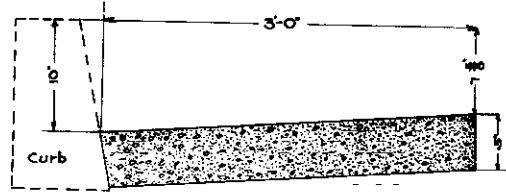
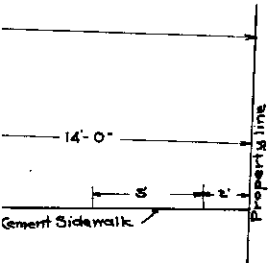

ENLARGED SECTION OF CONCRETE GUTTERS
 SCALE $\frac{1}{2}$ "=1'

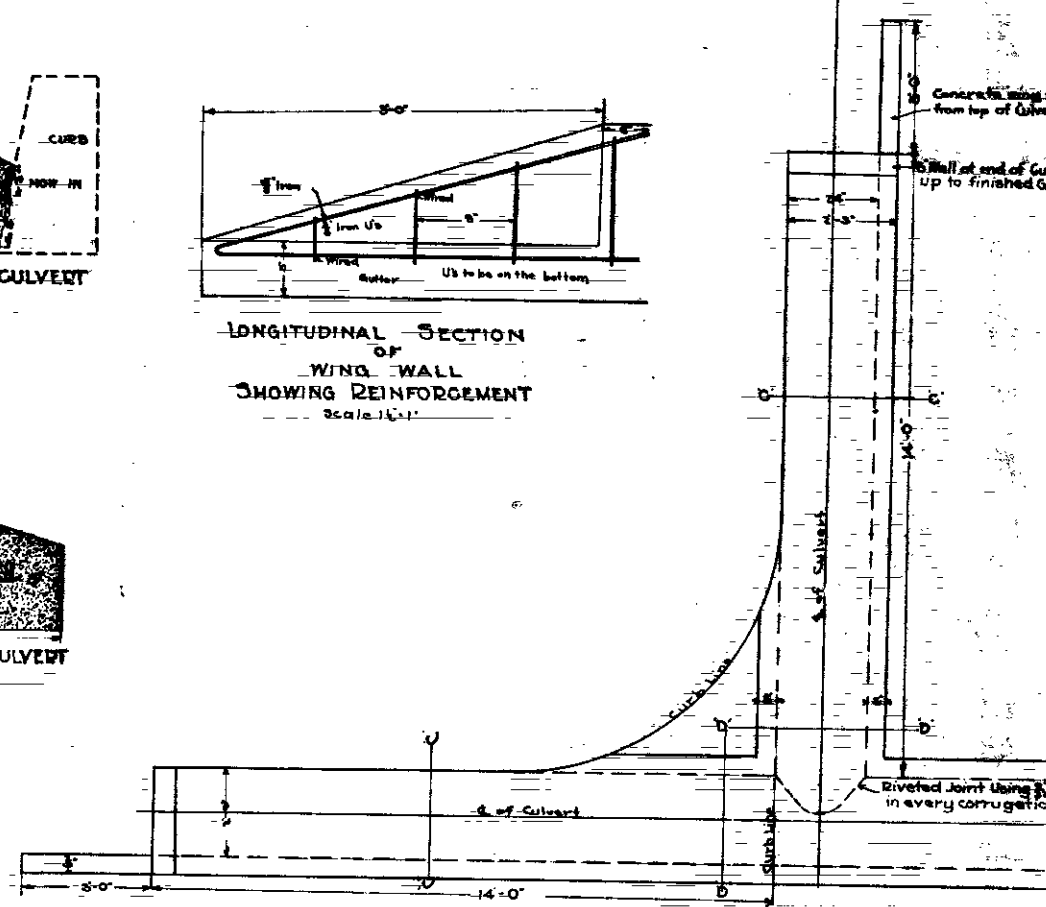
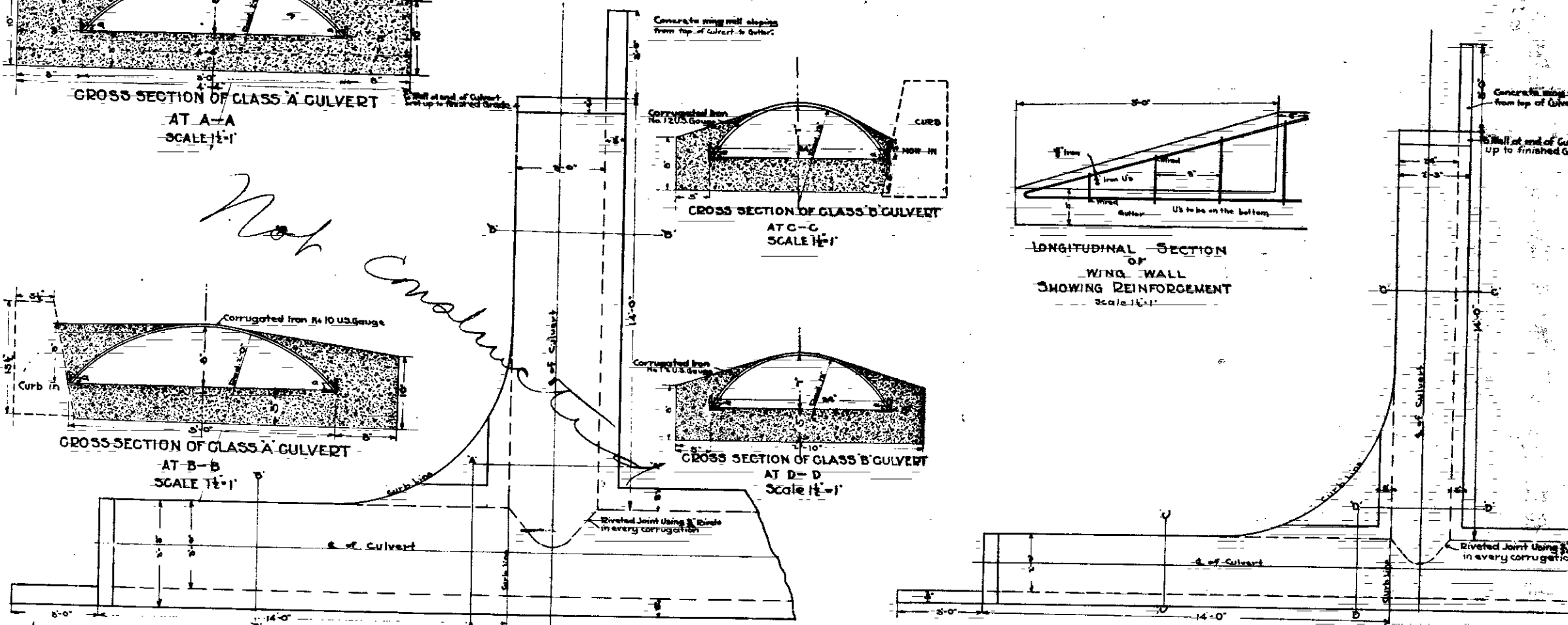
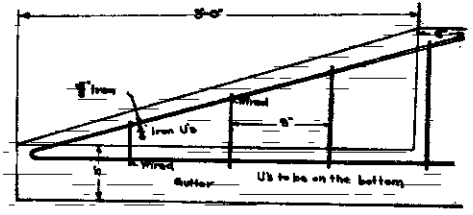
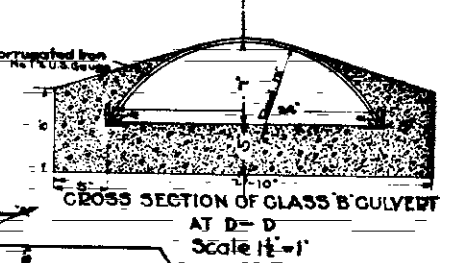
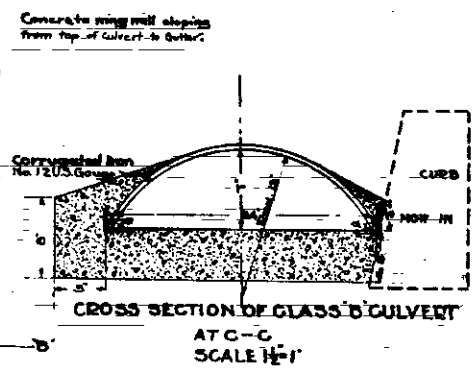
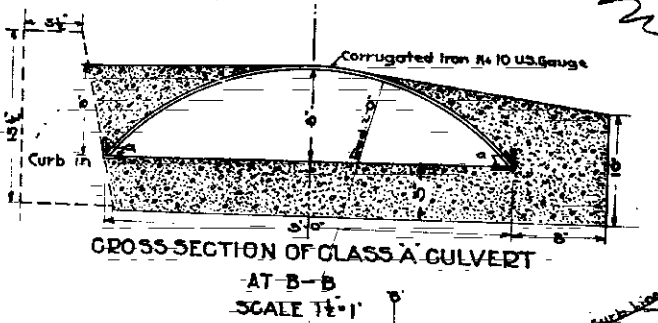
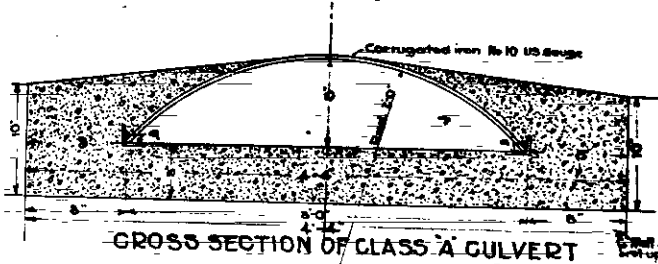

Not complete

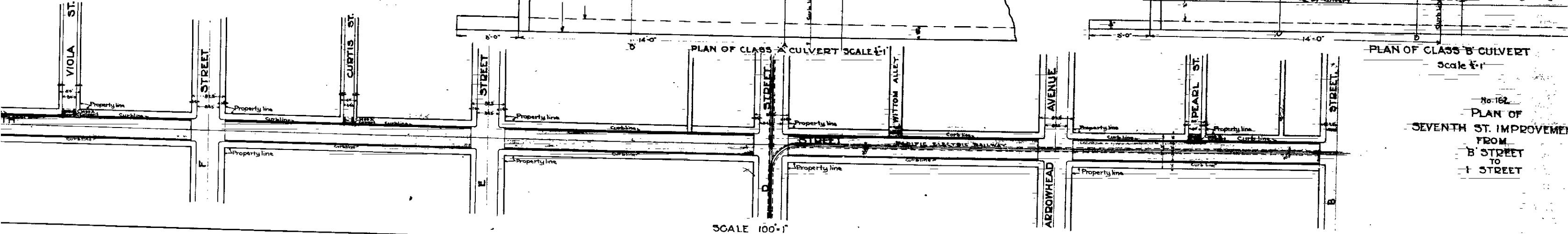

No. 162
 PLAN OF SEVENTH ST. IMPROVEMENT FROM B STREET TO I STREET